



**Building Envelope
(Curtain and Cavity Wall)
Products & Value Add Services**



SPI – Specialty Products & Insulation

- Leading value-add **Distributor and Specialty Fabricator** of insulation materials and related products, providing industry best service to our customers and suppliers
- Supplying Mechanical and Building Insulations and value add services for Thermal, Acoustic and fire Protection requirements.
- North American operations include 54 distribution and 13 co-located specialty fabrication facilities
- Industry Reputation for Quality, Innovation and Service

The screenshot shows the SPI website homepage. At the top is the SPI logo and the text 'Specialty Products & Insulation'. Navigation links include 'Locations', 'Contact Us', and a search bar. A yellow navigation bar contains links for 'Home', 'About SPI', 'Products & Services', 'Credit & Tax', 'Sustainability', 'Careers', and 'MSDS'. The main content area is divided into several sections: 'Locations' with a map of North America; 'The Value of Insulation' with a video player; 'Request for Quote' with a form and instructions; 'Products & Services' with sub-sections for 'Commercial & Industrial Insulation', 'Fabrication', 'GSD', 'Fire Protection', 'Acoustical', and 'Refractory'; 'Featured Product' with an image of a parking garage and a list of applications; and 'Follow Us:' with a LinkedIn icon.

spi Specialty Products & Insulation

Locations Contact Us
Search

Home About SPI Products & Services Credit & Tax Sustainability Careers MSDS

Locations

The Value of Insulation

Request for Quote

Use our Interactive RFQ tool to simplify your ordering process.

[Add items](#) to your Bill of Materials.
[Submit](#) your Bill of Materials.
[View](#) your Current Bill of Material.

Follow Us:

We're updating! Pardon our mess, our literature is being rebranded with the SPI Logo and name, however the same trusted, quality materials and products remain.

Products & Services

Commercial & Industrial Insulation
We represent the leading manufacturers of commercial, industrial, HVAC, building and metal building insulation products.

Fabrication
If you need it, we can fabricate it! Let our network of distribution and fabrication centers customize a solution for you.

GSD
We offer great depth and diversity in architectural, ceilings and wall systems, commercial building insulation and specialty products.

Fire Protection
Our specialization in passive fire protection provides the latest in cost effective solutions from industry leading manufacturers.

Acoustical
SPI is a distributor and fabricator of acoustical products and systems. We provide acoustical solutions for a broad range of Commercial, Industrial, Multifamily, Marine and OEM markets. Our fabricated products, capabilities and qualification testing allow us to offer customized solutions to meet specific application requirements.

Refractory
Supplying products to industries such as: Power, Petrochemical, Iron & Steel, Aluminum, Ceramic, Pulp & Paper and Incineration.

Marine
We offer Coast Guard / IMO approved hull board, pipe, duct and tank

Featured Product

New PG Board TAF Insulation!

For Parking Garage & Mechanical Room Applications

- Outstanding Thermal Insulation for Code Compliance
- Improves Space Acoustics
- Composite, Class A Fire Exposure Rating for Code compliance
- Bright White Finish Provides 85% Reflectivity
- Quick and Easy to Install
- Reduces Heating, Cooling and Lighting Costs!

[Click to learn more about PG Board TAF Insulation](#)

MI Branch & Fabrication Network

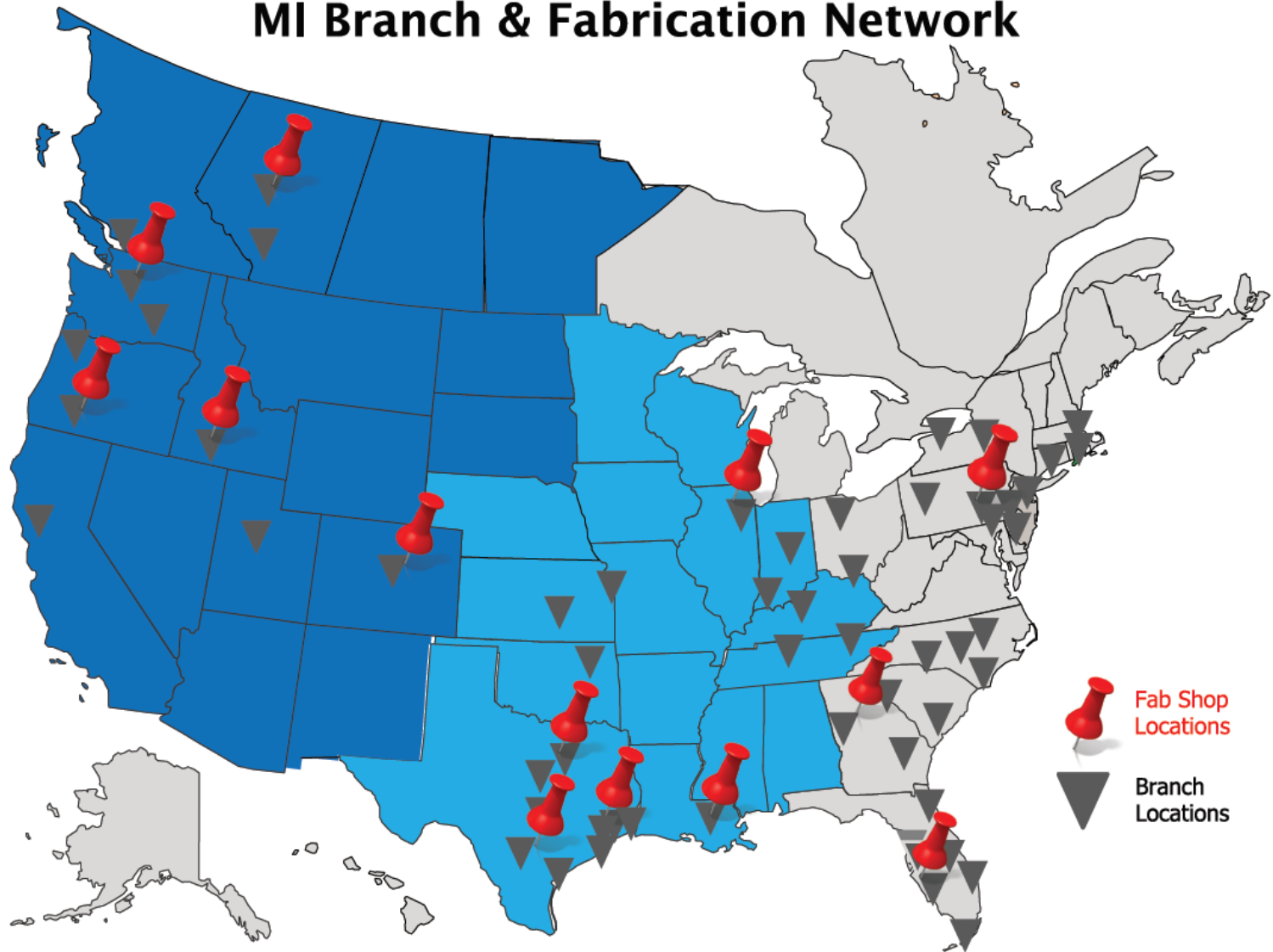

Mechanical Insulation Locations

Serving Domestic and International Customers

Primary Building Envelope Vendors

ROCKWOOL[®]
FIRESAFE INSULATION

Thermafiber[®]
THE NAME IN MINERAL WOOL™

STI[®] **FIRESTOP**

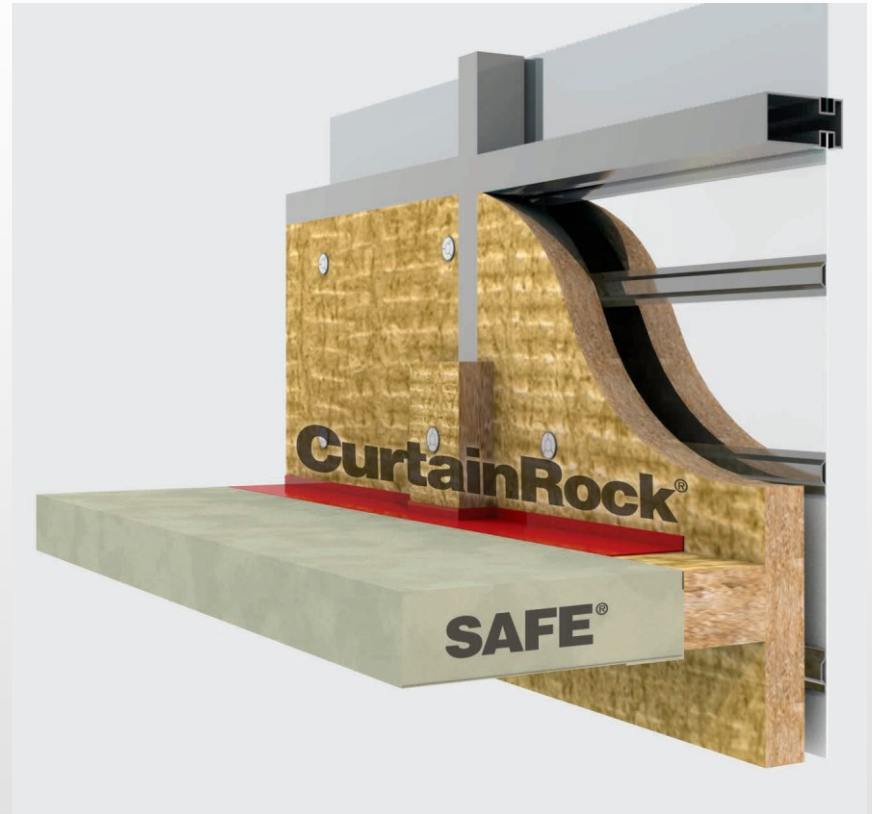

Fabrication Equipment - Band saws, shapers, routers and lamination equipment are used in our fabrication shops. CNC triple axis router, profiler etc. provide enhanced capability.

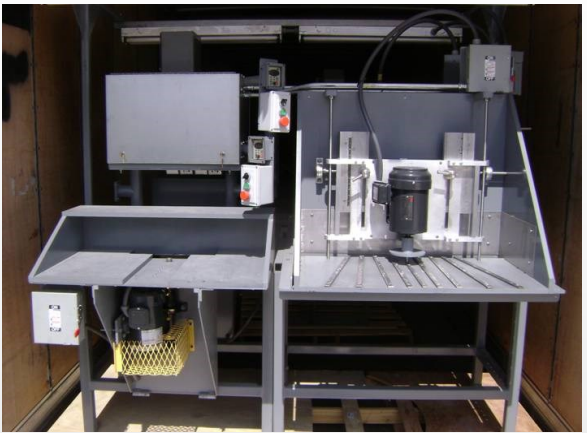

The Importance Of Proper Curtain Wall Protection

Imagine being trapped on an upper floor

First Interstate Bank
Los Angeles, CA



Dubai "Torch Tower"



London Grenfell Tower

Premature Loss of Containment

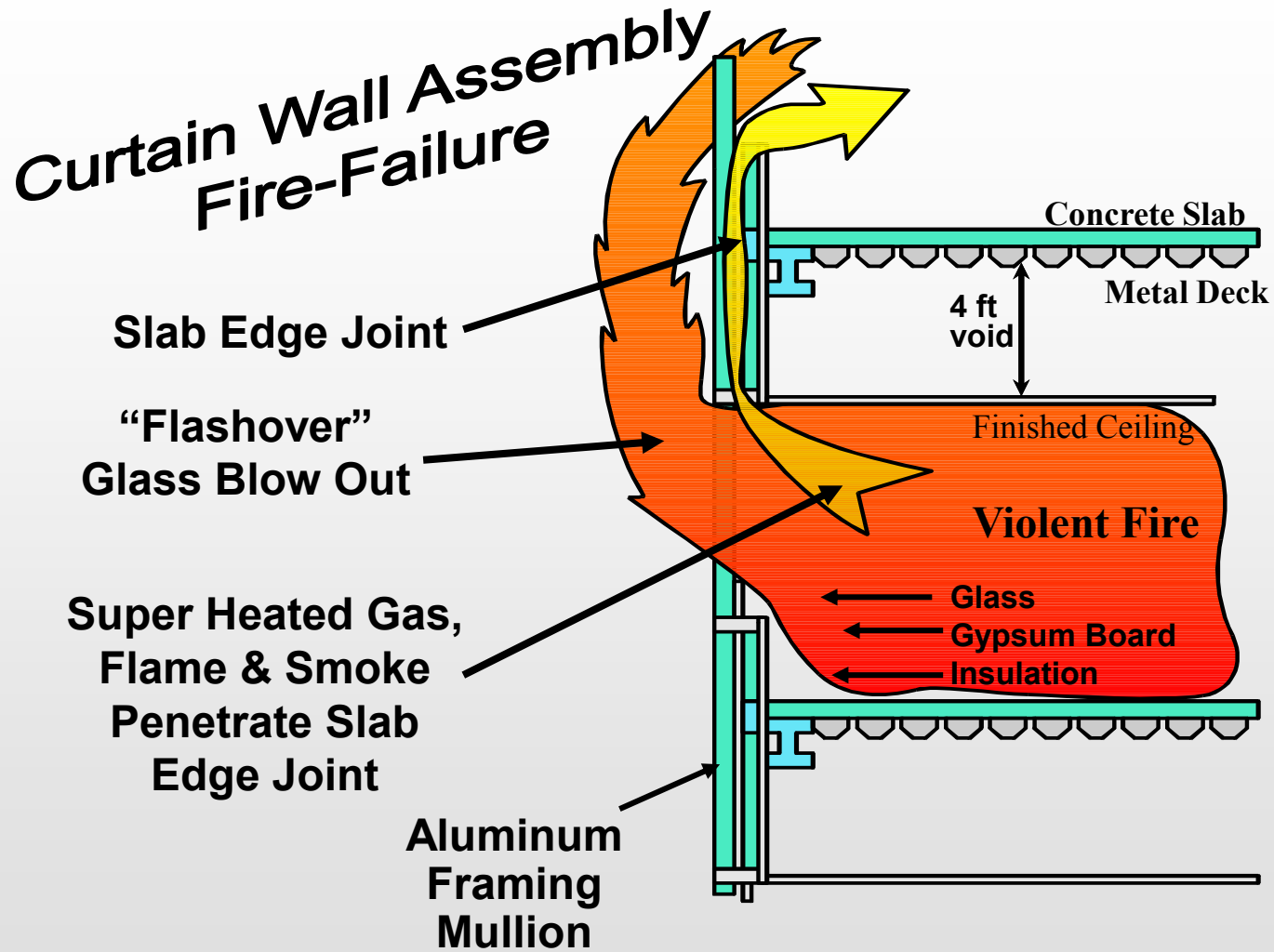

Properly Installed System Components

*A properly designed & tested
Perimeter Fire Barrier System
not only protects the perimeter
joint but critical wall framing and
support elements as well!*

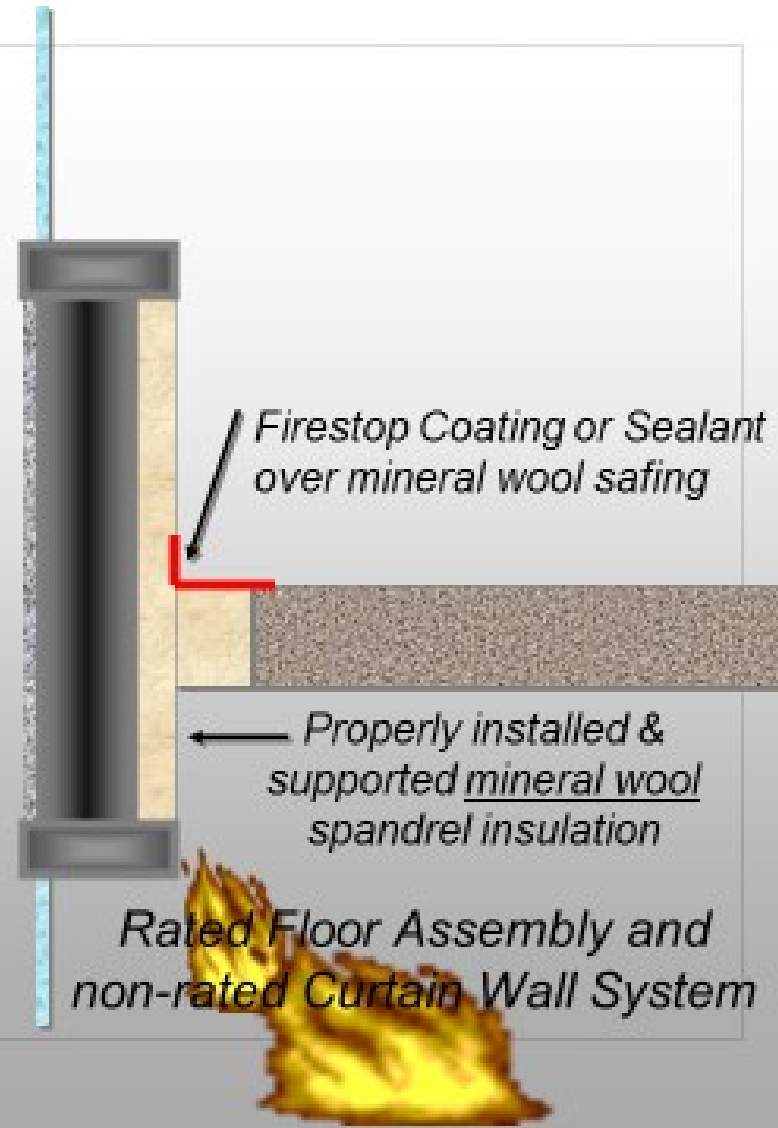

Curtain Wall Assembly Fire Test

Intermediate Scale Multi Story Fire Test, per NFPA 285



Aluminum melts away, steel framing and curtain wall insulation left intact



Steel framing

Non Combustible
Mineral wool

Interior View – After Fire Test

Joint system intact
after the test



Galvanized Steel Angles for Spandrel Insulation Attachment

Alternate Impasse hangers or 90° Insulation clips

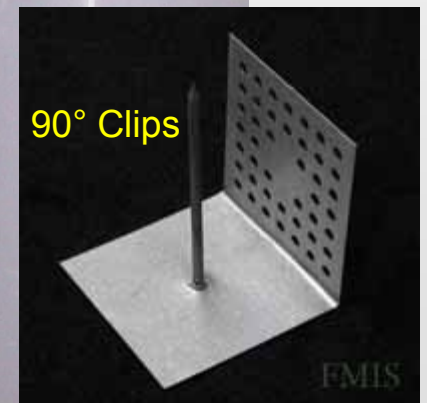

We also offer panels w/ Hangers installed

Typical T Bar Stiffener at Center Slab



Unacceptable Safing Packing

(Tightly pack correct density, thickness, with correct fiber orientation)



Loose, light density batt, not acceptable.

Perimeter Fire Containment Insulation System

1. Mechanically Attached Curtain Wall Insulation
2. Protect Aluminum Mullions
3. Compression-Fit Safing Insulation w/ Safing Clips (per tested assembly details)

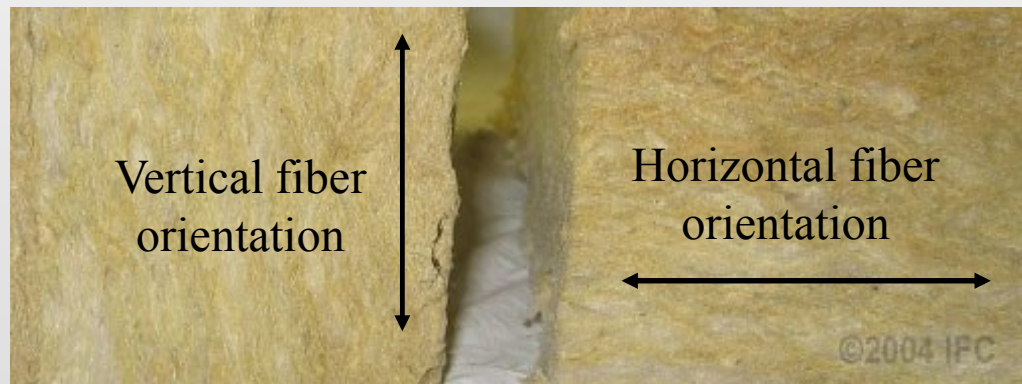

4lb. Safing Installed w/ Vertical Fiber Orientation



Cup Head CD Pins



**Curtain wall insulation fastened to steel angle
Project R Value drive insulation thickness (2-6" Typical)**

Safing Insulation Matches As Tested Thickness, Density & Orientation



Mullion Covers Fastened with Spiral Anchors



Curtain Wall System With Mullions Protected



Joints taped to maintain system vapor barrier
Firestop spray completes the system

SPI Supplied Curtain Wall Products & Fabrication Service

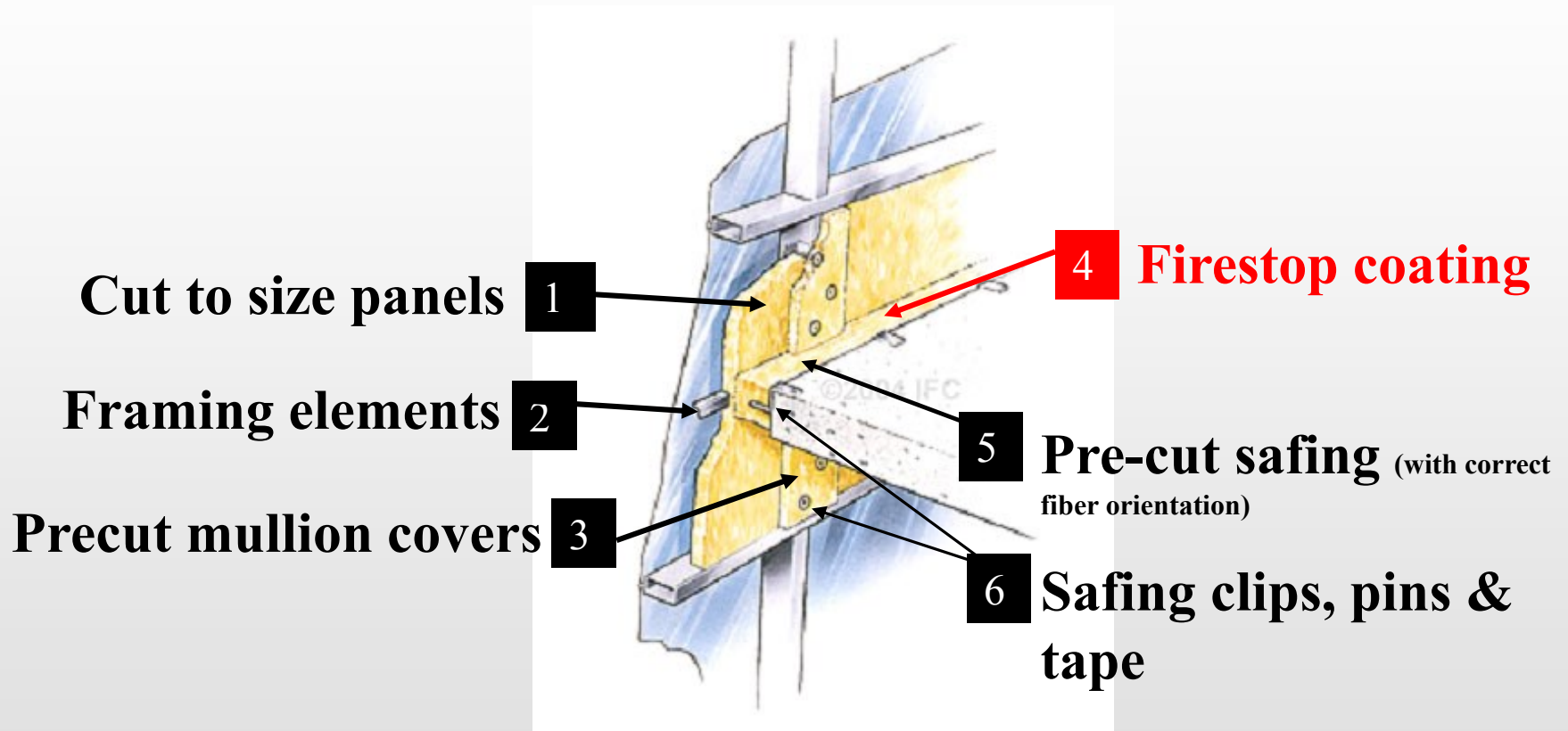

Supplied When and Where you Need it!

432 Park Avenue, NY (tallest residential tower in the western hemisphere)



The tower at 432 Park Avenue in New York. Photograph: dbox/CIM Group & Macklowe Properties

Shop Installed "Cut to Size" Insulation Components

- Reduced: material handling, storage space, damage, labor cost, clean up, disposal fees and environment dust

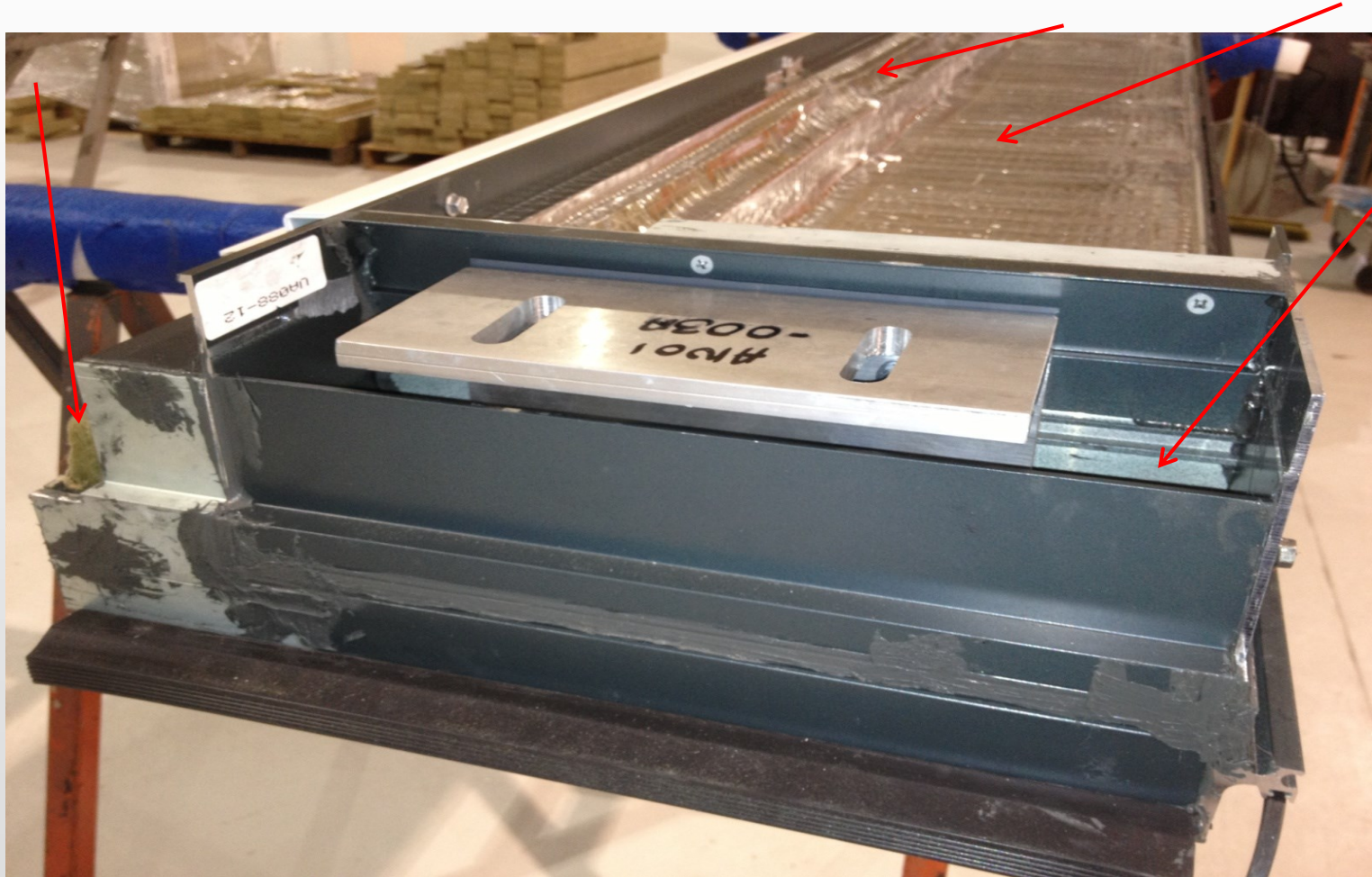

Field Installed "Cut to Size" Curtain Wall Insulation System

Reduces material handling, storage space, damage, labor time / cost, clean up and disposal fees



Curtain Wall Insulation / Safing Service Case History

Project: GlaxoSmithKline, Five Crescent Dr., Philadelphia
Navy Yard Corporate Center, Philadelphia, PA
Project Architect: Robert A M Stern Architects
General Contractor: L. F. Driscoll Company
Installing Contractor: Pyro-Stop, LLC

Project Detail: Four story 205,000 square foot steel structure with a glass curtain wall exterior, designed to achieve LEED Platinum certification, the highest designation in the sustainable building rating system.



Scott Rankin, Pyro-Stop President, reports Pyro-Stop was awarded the project because of our reputation for expert craftsmanship and ability to complete difficult projects ahead of schedule. The project schedule was very aggressive and made more difficult due to sequencing of other trades. "SPO's panel service minimized waste, reduced handling and job site cleanup as well as site material distribution time improving overall production." Our customer was extremely pleased with the installation strategy and workmanship.

Pyro-Stop awarded the material contract to SPO due to their specialty fabrication services for thermal, acoustical and fire protection materials and quick turnaround capability. SPO provided panels cut-to-size per curtain wall openings to meet an aggressive delivery schedule while satisfying Pyro-Stop's insulation budget. Exterior curtain wall panel sizes were typically five feet wide by seven feet high. The project required five inch thick insulation panels composed of eight pound density mineral fiber which would weigh over 115 pounds each. Having panels supplied pre-cut, in manageable sections made the installation easier.

Pyro-Stop Project Manager, Jim Andorko reports "We'll use SPO's Curtain wall, Safing, FirePlug® and FireStrip® insulation fabrication service on future projects. The cut-to-size and conveniently packaged materials resulted in decreased set up time and substantial productivity improvement." We also believe SPO's fabrication services will facilitate project schedule improvements, helping us secure additional work.



Capability – Stock Sizes, Value Add Cut to Size Panels



Mineral Wool Insulated Steel Back Pans External, Extruded Polystyrene Foam Insulated Wall Light Troffers

Steel Back Pan

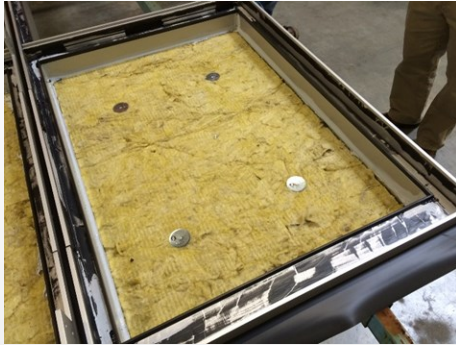

Cut to size w/routed grooves



Tysons Corner, VA

Curtain Wall Acoustic Performance

- International Green Construction Code (Proximity to noise)
 - 1000 feet from expressway
 - 2 miles from airport
 - Average day level is 65 dB
 - Requires O.I.T.C. of 40

- OITC Rated Curtain Wall Assembly (best practice)
 - Thermal break framing
 - Heavier glass
 - Optimized spandrel size
 - Framing insulation inserts
 - Addressed panel joint seals
 - Increased spandrel insulation thickness
 - Include composite mass vinyl barrier with insulation



Products & Services

[C & I Insulation](#)[Fabricated](#)[GSD](#)[Fire Protection](#)[Acoustical](#)[Refractory](#)[Marine](#)[OEM](#)[Specialty](#)[Manufacturing Partners](#)[Product Data Sheets](#)[CA Proposition 65](#)

Acoustical Products

The list of Commercial, Industrial, Marine and OEM acoustical products highlights the type of products and services available from our North American network of distribution and fabrication centers. For a complete listing of acoustical products and services, please contact a nearby [SPI location](#). We are extremely proud to represent the leading manufacturers in the industries we service.

Product List

- [Absorption Plus® Acoustical Wall Panels](#)
- [Acoustical Baffles \(Link to Absorption Plus baffle datasheet\)](#)
- Acoustical Fire Batt (AFB)
- [Acoustical Panels](#)
- Acoustical Ceilings
- Acoustical Sealants
- Acoustical Foam Insulation
- Acoustical Putty Pad
- Acoustical Spray Foam
- Acoustical Accessories
- Composite Acoustical Panels
- [Curtain Wall Insulation](#)
- [Deck Plugs \(fiberglass, mineral wool and elastomeric foam\)](#)
- Duct Acoustical / Thermal Insulation
- Electrical Outlet Acoustic Putty Pads
- Fabricated Acoustical Specialties
- Fiberglass Acoustical Batt and Board
- ["Imagine" Digital Image Acoustical Panels](#)
- Isolation hangers
- [Light Fixture Sound Blocking Covers](#)
- [Marine Acoustical Specialties](#)
- Mass Loaded Vinyl
- Mineral Wool Acoustical Batt and Board
- Noise Abatement Products
- [PG Board TAF](#)
- Pipe Acoustical / Thermal Insulation
- [SafeLite® Sound Blocking Fixture Covers](#)
- Sound Attenuation Batt (SAB)
- SoundSoak® Acoustical Panels
- Tectum Panels
- Theater and Conference Room Systems
- Vibration Dampening Composites

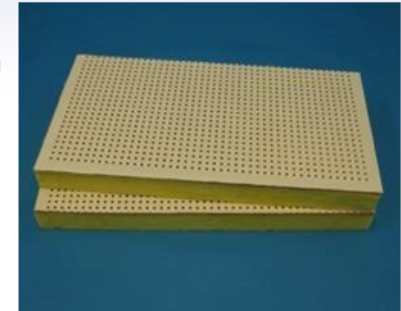

Special Shape Insulation Framing Inserts



Precision Machined Shapes - Framing Inserts Provide
Enhance Thermal and Acoustic Performance



Capability - Thermal / Acoustic Composites with Mass Barriers, etc.

Combine thermal insulation with sound absorption and barriers to dampen vibrations and block noise transmission (O.I.T.C.)

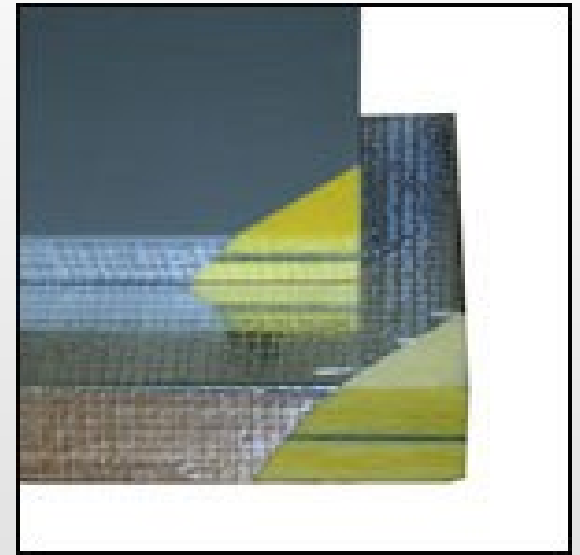
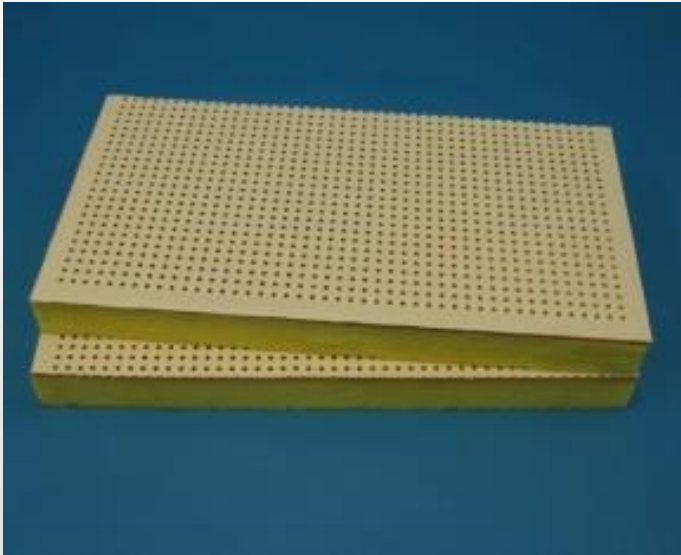

O.I.T.C. Sound Blocking, Mass Vinyl Curtain Wall Framing Components (Composites, Shapes and Cut to Size Sheet)



Curtain Wall Project Examples (Small to Large)

Local Community Hospital



432 Park Avenue, NY



*NY, Hudson Yard
Tower C*



*250 South Street
Pathmark*



Pre-Fab Service Adds Value (reduce injuries and claims)

- Labor shortage / skilled labor jobs are hard to fill
 - The first six months of employment are most risky for injuries to new tradespeople
 - **Increased insurance claims**
 - Shortage of experienced trade workers has led to increased on-the-job injuries and construction defects
- (Refs., Manpower Group, Liberty Mutual Construction Practice)



Custom Project Materials When & Where Needed

■ Risk Management

- Fixed vs. Variable Cost
- Reduces Direct Labor
- Reduces Material Usage – Waste
- Reduces Material Inventory Dollars
- Reduces Storage, Material Damage and Delivery Charges
- **Safety**, Risk Management – Reduced Injury, Accidents, Claims and Insurance Costs



Adding “Measurable” VALUE !

Cavity Wall Insulation (stock and cut to size panels)



Typical Customers

- CW Fabricators and Erectors
- Glazing companies
- Thermal Insulators
- Drywall Contractors
- Firestop Contractors
- GC's that self perform



Products & Services

[C & I Insulation](#)

[Fabricated](#)

[GSD](#)

[Fire Protection](#)

[Acoustical](#)

[Refractory](#)

[Marine](#)

[OEM](#)

[Specialty](#)

[Manufacturing Partners](#)

[Product Data Sheets](#)

[CA Proposition 65](#)

Fire Protection Products

A distributor and fabricator specializing in passive fire protection products. Specialty Products and Insulation offers fire rated solutions for a broad range of applications. Our specialization in passive fire protection provides you with the latest cost effective solutions from industry leading manufacturers. Together with our fabricated products and diverse fabrication capabilities we provide superior solutions that save time and money!



[Fire Protection Line Card](#)
[Curtain and Cavity Wall Products and Services](#)

Fire Protection Applications:

- [Penetration and construction joints](#)
- [SafeLite® UL listed light cover](#)
- [FirePlug® / FireStrip®](#)
- [Curtain wall](#)
- [Kitchen exhaust, grease duct](#)
- [Clothes dryer duct](#)
- [Return air plenum](#)
- [Conduit and cable tray](#)
- [Structural fire proofing](#)
- [Fire retardant coatings](#)
- [Access doors and roof hatches](#)
- [Tools and equipment](#)

Fire Protection Services:

SPI provides the following services in conjunction with partner manufacturers.

- Training programs for contractors, facility maintenance, architects, engineers, building inspectors, code officials and insurance industry representatives
- Submittal assistance
- Secure engineering judgments for unusual conditions
- Product comparison and equivalency evaluation
- Job site support

SPI is a member of the International Code Council, National Fire Protection Association and Firestop Contractor International Association





Curtain and Cavity Wall Products and Services

- Supplying "cut to size" panels, shapes, and more for major labor savings
- Delivered when you need it
- Composite acoustical systems include: Mass loaded vinyl for increased O.I.T.C.
- Specialty facing laminations
- UL Certified Firestop systems
- System fasteners (pre-installed), safing clips and tapes
- Related framing components: angle, hat channel, T bar, etc.
- Firestop spray pumps, pin welders and related tools
- Personnel protective equipment



Precut Insulation & Safing



Precut Mullion Covers



Firestop Systems



Framing Insert Shapes



Serving Curtain Wall & Back Pan Fabricators, Insulators, Glazers and Firestop Contractors

Our PG Board TAF™ Satisfies Code Requirements for Parking Garage and Other Applications

Call (855) 519 - 4044
Or email
Fabteam@spi-co.com